

BM3... MULTI STATION SUBPLATE

BM3...

BM

Multi station subplate (standard versions are supplied in cast iron material)

3

CETOP 3/NG6

50 = Connected in parallel with pressure relief valve and rear connectors
70 = Connected in parallel with pressure relief valve and side connectors
52 = Connected in series with pressure relief valve and rear connectors
72 = Connected in series with pressure relief valve and side connectors
60 = Connected in parallel without pressure relief valve and side connectors

No. of valve seats
2 / 3 / 4 / 5 / 6 / 7 / 8

Type of adjustment (omit for BM360 version)
M = Plastic knob
C = Grub screw

Setting range (omit for BM360 version)
1 = max. 50 bar (**white spring**)
2 = max. 150 bar (**yellow spring**)
3 = max. 320 bar (**green spring**)

00 = No variant
AL = in aluminium material versions (recommended pressure max. 230 bar)

1

Serial No.

• The minimum permissible setting pressure depending on the spring:
 see cartridge valve type CMP10... Cap. VII • 30

7

BM360 CONNECTED IN PARALLEL WITHOUT PRESSURE RELIEF VALVE

Type	A	B	Weight(Kg)
BM360/2	120	108	3,6
BM360/3	170	158	5,1
BM360/4	220	208	6,7
BM360/5	270	258	8,2
BM360/6	320	308	9,7
BM360/7	370	358	11,2
BM360/8	420	408	12,6

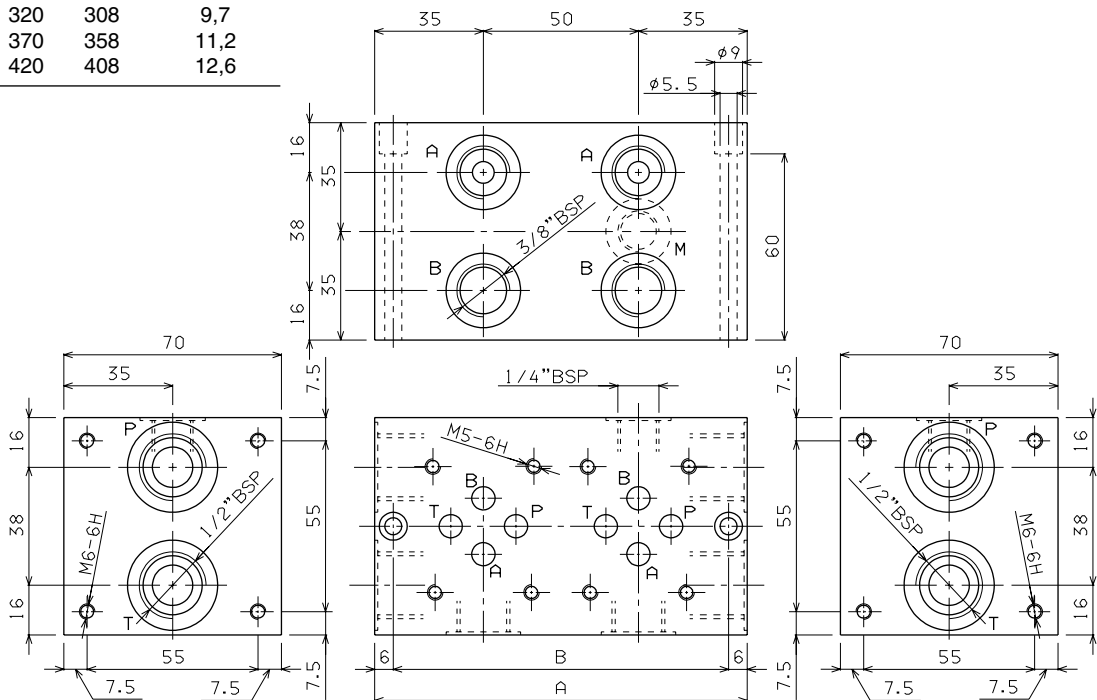
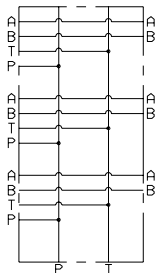

Fixing screws M5x70 UNI 5931

BM3... MULTI STATION SUBPLATE

BM350 CONNECTED IN PARALLEL WITH PRESSURE RELIEF VALVE

The drawing includes an electrical schematic on the left showing a parallel connection of 8 stations. The top view shows a rectangular subplate with a central pressure relief valve (CMP 10) and 8 ports (P, T, B, M). Dimensions include a total length of 52, a distance of 19.5 from the left edge to the first port, and a distance of 32.5 between ports. The side view shows a height of 45.8 and a diameter of 6.5. A detailed view of the ports shows a 1/4" BSP inlet, 3/8" BSP outlets, and M5-6H and M6-6H mounting holes. The overall dimensions are 152.5 x 80 mm.

Type	A	B	Weight(Kg)
BM350/2	141	126	4,6
BM350/3	191	176	6,1
BM350/4	241	226	7,6
BM350/5	291	276	9,1
BM350/6	341	326	10,6
BM350/7	391	376	12,1
BM350/8	441	426	13,6

Fixing screws M6x55 UNI 5931

7

BM370 CONNECTED IN PARALLEL WITH PRESSURE RELIEF VALVE

The drawing includes an electrical schematic on the left showing a parallel connection of 8 stations. The top view shows a rectangular subplate with a central pressure relief valve (CMP 10) and 8 ports (P, T, B, M). Dimensions include a total length of 160, a distance of 35 from the left edge to the first port, and a distance of 50 between ports. The side view shows a height of 60 and a diameter of 9. A detailed view of the ports shows a 1/4" BSP inlet, 3/8" BSP outlets, and M5-6H and M6-6H mounting holes. The overall dimensions are 127.5 x 70 mm.

Type	A	B	Weight(Kg)
BM370/2	160	148	4,9
BM370/3	210	198	6,4
BM370/4	260	248	7,9
BM370/5	310	298	9,4
BM370/6	360	348	10,9
BM370/7	410	398	12,4
BM370/8	460	448	13,9

Fixing screws M5x70 UNI 5931

BM3... MULTI STATION SUBPLATE

BM352 CONNECTED IN SERIES WITH PRESSURE RELIEF VALVE

Technical drawing of the BM352 subplate. It includes a top view showing a grid of ports labeled P, T, and M, with dimensions for overall size (max. 152.5 x max. 57.5) and individual port spacing. A side view shows the subplate's profile with a height of 46 and a 3/8" BSP connection. A detail view shows a port with a 1/4" BSP connection and an M5-6H screw. Another detail shows a port with an M8-6H screw and a 1/2" BSP connection. A pressure relief valve (CMP 10) is also indicated.

Type	A	B	Weight(Kg)
BM352/2	141	126	4,6
BM352/3	191	176	6,3
BM352/4	241	226	7,6
BM352/5	291	276	9,2
BM352/6	341	326	10,7
BM352/7	391	376	12,2
BM352/8	441	426	13,7

Fixing screws M6x55 UNI 5931

7

BM372 CONNECTED IN SERIES WITH PRESSURE RELIEF VALVE

Technical drawing of the BM372 subplate. It includes a top view showing a grid of ports labeled P, T, and M, with dimensions for overall size (max. 127.5 x max. 57.5) and individual port spacing. A side view shows the subplate's profile with a height of 70 and a 3/8" BSP connection. A detail view shows a port with a 1/4" BSP connection and an M5-6H screw. Another detail shows a port with an M6-6H screw and a 1/2" BSP connection. A pressure relief valve (CMP 10) is also indicated.

Type	A	B	Weight(Kg)
BM372/2	160	148	4,9
BM372/3	210	198	6,4
BM372/4	260	248	7,9
BM372/5	310	298	9,4
BM372/6	360	348	10,9
BM372/7	410	398	12,4
BM372/8	460	448	13,9

Fixing screws M5x70 UNI 5931